

### Clamp pipe connection DIN 32676, flange Ø 34–319

Art.Nr. EUR Art.Nr. EUR

#### Clamping ring FL-Solid

TÜV Bauteilprüfung  
TÜV Type-test

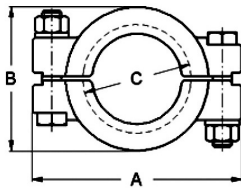

DN	A	B	C	Ø Flange			AISI304	
25-40	102,5	70	53,1	50,5			210916	28,40
50	115	82	66,5	64			210905	30,60
2,5"	128	96	79,9	77,5			210906	36,20
65	140	109	93	91			210907	40,40
80	152	122	110	106			210938	43,20
100	166	134	121,2	119			210908	45,90
115	178	146	134	130			210909	60,30
125	212,5	176	159	155			210910	97,20
150	243	204	187	183			210911	115,30
200	294	254,5	237,5	233,5			210912	142,70

#### Clamp gasket DIN

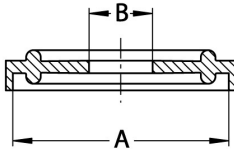

DN	A	B				EPDM		EPDM USP VI	
10	34	10,2				220630	1,20	223630	Enquiry
15	34	16,2				220631	1,20	223631	Enquiry
20	34	20,2				220632	1,20	223632	Enquiry
25	50,5	26,2				220633	1,30	223633	Enquiry
32	50,5	32,2				220634	1,30	223634	Enquiry
40	50,5	38,2				220635	1,30	223635	Enquiry
50	64	50,2				220636	1,70	223636	Enquiry
65	91	66,2				220637	2,80	223637	Enquiry
80	106	81,2				220638	3,20	223638	Enquiry
100	119	100,2				220639	4,30	223639	Enquiry
115 *	130	110,5				220609	11,50	223609	Enquiry
125	155	125,2				220641	13,10	223641	Enquiry
150	183	150,2				220642	15,40	223642	Enquiry
200	233,5	200,2				220644	18,30	223644	Enquiry
250 *	268	250,2				220646	Enquiry	223646	Enquiry
300 *	319	300,2				220648	Enquiry	223648	Enquiry

\* Similar to DIN 32676

#### Clamp gasket DIN

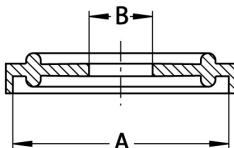

DN	A	B				FKM		FKM USP VI	
10	34	10,2				220830	4,50	224230	Enquiry
15	34	16,2				220831	4,50	224231	Enquiry
20	34	20,2				220832	4,50	224232	Enquiry
25	50,5	26,2				220833	4,60	224233	Enquiry
32	50,5	32,2				220834	4,60	224234	Enquiry
40	50,5	38,2				220835	4,60	224235	Enquiry
50	64	50,2				220836	5,50	224236	Enquiry
65	91	66,2				220837	9,40	224237	Enquiry
80	106	81,2				220838	10,80	224238	Enquiry
100	119	100,2				220839	11,90	224239	Enquiry
115 *	130	110,5				220809	16,70	224209	Enquiry

\* Similar to DIN 32676

**LINNEMANN**  
Rohrverbindungen • Edelstahlarmaturen  
Pipe connections • Stainless steel fittings

LINNEMANN GmbH • Heerweg 14–16  
72070 Tübingen / Germany

Fon: +49 (0) 7071 97555-0  
Fax: +49 (0) 7071 97555-10

E-Mail: info@linnemann-online.com  
Internet: www.linnemann-online.com

**Clamp pipe connection DIN 32676, flange Ø 34–319**
**Art.No**
**EUR**
**Art.No**
**EUR**
**Clamp gasket DIN**

DN	A	B				FKM		FKM USP VI	
125	155	125,2				220841	22,30	224241	Enquiry
150	183	150,2				220842	25,40	224242	Enquiry
200	233,5	200,2				220844	34,70	224244	Enquiry
250 *	268	250,2				220846	Enquiry	224246	Enquiry
300 *	319	300,2				220848	Enquiry	224248	Enquiry

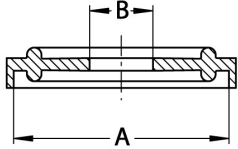

\* Similar to DIN 32676

**Clamp gasket DIN**

DN	A	B				PTFE		PTFE USP VI	
10	34	10				221130	9,20	224530	Enquiry
15	34	16				221131	9,20	224531	Enquiry
20	34	20				221132	9,20	224532	Enquiry
25	50,5	26				221133	9,60	224533	Enquiry
32	50,5	32				221134	9,60	224534	Enquiry
40	50,5	38				221135	9,60	224535	Enquiry
50	64	50				221136	10,70	224536	Enquiry
65	91	66				221137	16,20	224537	Enquiry
80	106	81				221138	17,90	224538	Enquiry
100	119	100				221139	19,70	224539	Enquiry
115	130	109,7				221109	21,30	224509	Enquiry
125	155	125				221141	27,50	224541	Enquiry
150	183	150				221142	35,90	224542	Enquiry
200	233,5	200				221144	49,40	224544	Enquiry
250	268	250				221146	Enquiry	224546	Enquiry
300	319	300				221148	Enquiry	224548	Enquiry

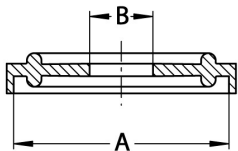
**Clamp gasket DIN**

DN	A	B				VMQ		VMQ USP VI	
10	34	10,2				220730	1,30	223930	Enquiry
15	34	16,2				220731	1,30	223931	Enquiry
20	34	20,2				220732	1,30	223932	Enquiry
25	50,5	26,2				220733	1,40	223933	Enquiry
32	50,5	32,2				220734	1,40	223934	Enquiry
40	50,5	38,2				220735	1,40	223935	Enquiry
50	64	50,2				220736	1,90	223936	Enquiry
65	91	66,2				220737	3,20	223937	Enquiry
80	106	81,2				220738	3,70	223938	Enquiry
100	119	100,2				220739	4,80	223939	Enquiry
115 *	130	110,5				220709	13,60	223909	Enquiry
125	155	125,2				220741	15,70	223941	Enquiry
150	183	150,2				220742	18,30	223942	Enquiry
200	233,5	200,2				220744	25,50	223944	Enquiry

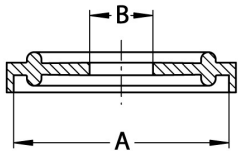

\* Similar to DIN 32676

### Clamp pipe connection DIN 32676, flange Ø 34–319

Art.No    EUR    Art.No    EUR

#### Clamp gasket DIN

DN	A	B				VMQ		VMQ USP VI	
250 *	268	250,2				220746	Enquiry	223946	Enquiry
300 *	319	300,2				220748	Enquiry	223948	Enquiry

\* Similar to DIN 32676

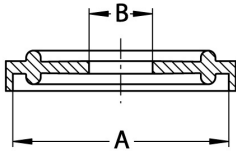

#### Clamp gasket DIN, enveloped

DN	A	B				PTFE-FKM		PTFE-FKM USP VI	
10	34	10				221830	11,40	224830	Enquiry
15	34	16				221831	11,40	224831	Enquiry
20	34	20				221832	11,40	224832	Enquiry
25	50,5	26				221833	12,70	224833	Enquiry
32	50,5	32				221834	12,70	224834	Enquiry
40	50,5	38				221835	12,70	224835	Enquiry
50	64	50				221836	13,20	224836	Enquiry
65	91	66				221837	17,60	224837	Enquiry
80	106	81				221838	18,70	224838	Enquiry
100	119	100				221839	20,60	224839	Enquiry
115	130	109,7				221809	22,00	224809	Enquiry
125	155	125				221841	28,50	224841	Enquiry
150	183	150				221842	37,80	224842	Enquiry
200	233,5	200				221844	54,90	224844	Enquiry
250	268	250				221846	71,50	224846	Enquiry
300	319	300				221848	83,60	224848	Enquiry

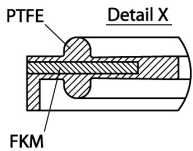
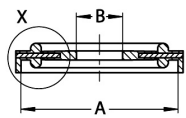

#### Clamp gasket ASME

DN	A	B				EPDM		EPDM USP VI	
1"	50,5	23,1				225703	1,30	225603	Enquiry
1,5"	50,5	35,3				225704	1,30	225604	Enquiry
2"	64	48				225705	1,70	225605	Enquiry
2,5"	77,5	60,7				225706	2,30	225606	Enquiry
3"	91	73,1				225707	2,80	225607	Enquiry
4"	119	97,8				225708	4,30	225608	Enquiry
4,5" *	130	110,5				225709	11,50	225609	Enquiry
5,5" *	155	135,9				225710	13,10	225610	Enquiry
6,6" *	183	163,3				225711	15,40	225611	Enquiry
8,6" *	233,5	214,1				225712	18,30	225612	Enquiry

\* Similar to DIN 32676

